

USH 2 - STH 13 SIGNALIZED INTERSECTION

ALL TRAFFIC THROUGH INTERSECTION
SIGNAL CONTROLLED INTERSECTION.
LIGHT TIMING TO BE DETERMINED.
SIGNIFICANT DELAYS EXPECTED
DURING RED LIGHTS.

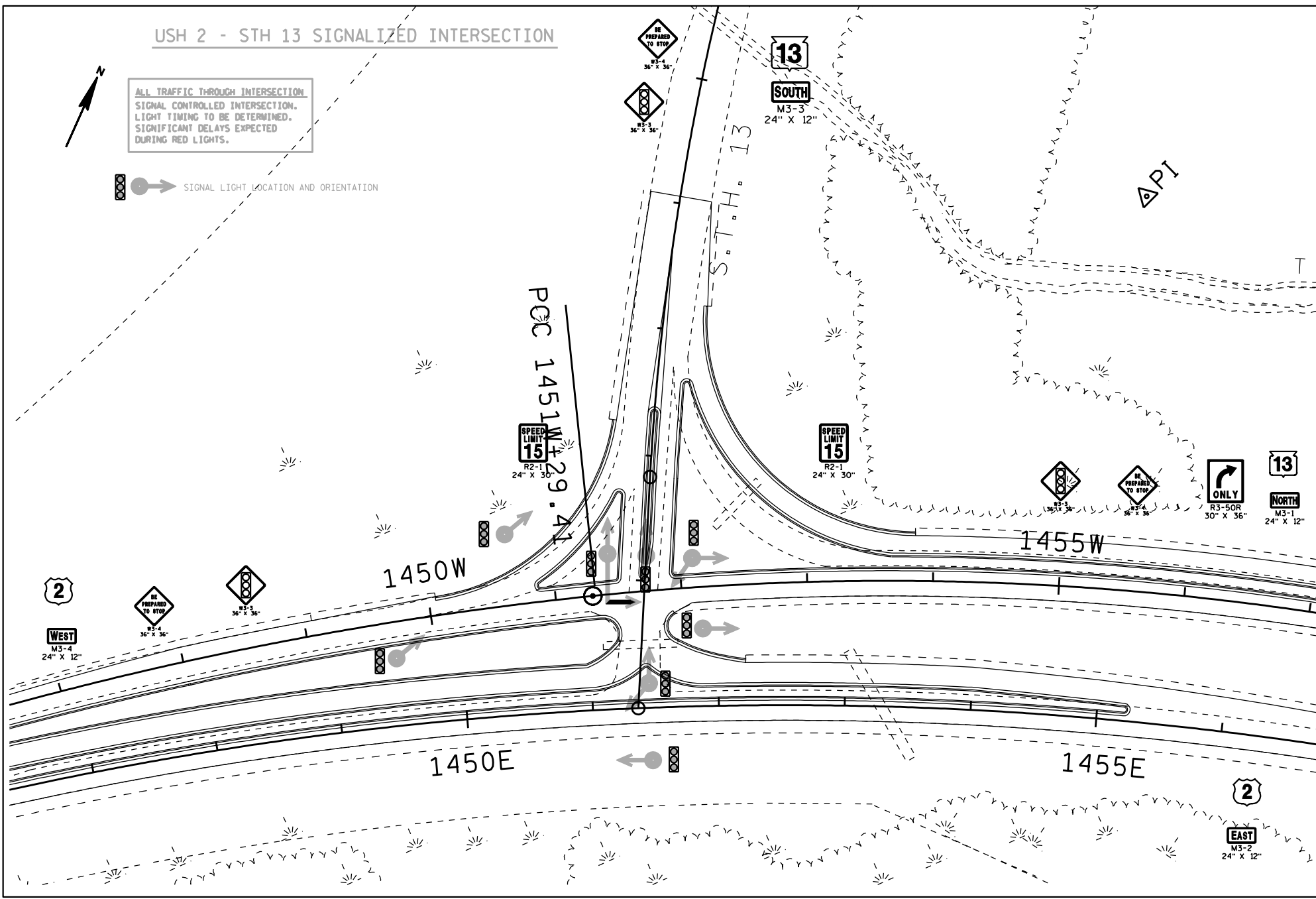

 SIGNAL LIGHT LOCATION AND ORIENTATION



USH 2 AND STH 13 INTERSECTION, BAYFIELD COUNTY

13

STH 13 SOUTH

EAST BOUND
ENTER THE CIRCLE WHEN AN OPENING EXISTS
PROCEED AROUND THE CIRCLE TO THE EAST
BOUND EXIT.

WEST BOUND
ENTER THE CIRCLE WHEN AN OPENING EXISTS.
PROCEED WITH AN IMMEDIATE RIGHT TURN
INTO THE WEST BOUND USH 2 MERGE LANE LANE.

SEE LINE STYLE - - - - -

USH 2 EAST BOUND TO STH 13 NORTH

MOVE TO LEFT LANE ROUNDABOUT APPROACH.
SLOW TO ENTRY SPEED AND ENTER WHEN AN
OPENING IS AVAILABLE. PROCEED AROUND
THE CIRCLE AND EXIT STH 13 NORTH.

SEE LINE STYLE - - - - -

DISABLED VEHICLES

APPROACHES ARE DESIGNED TO ALLOW
VEHICLES TO PASS A DISABLED VEHICLE.
SLOW TO ENTRY SPEED AND PROCEED
AROUND THE DISABLED VEHICLE WHEN
YOU HAVE DETERMINED IT IS SAFE.

USH 2 WEST BOUND TO STH 13 NORTH

**BYPASS LANE ELIMINATES TRAVEL THROUGH
ROUNDABOUT INTERSECTION**

SEE LINE STYLE _____

LARGE VEHICLES

THE CIRCLE IS DESIGNED TO ACCOMODATE
THE LARGEST TRACTOR TRAILER ON OUR
ROADS (WB-65). IN MOST CASES THE REAR
OF THE TRUCK WILL JUST TOUCH THE CURB.
FOR THE FEW UNIQUE VEHICLES ON THE ROAD,
THE REAR WHEELS CAN RIDE UP ON THE
CENTRAL TRUCK APRON.

EMERGENCY VEHICLES

APPROACHES ARE DESIGNED TO ACCOMODATE
EMERGENCY VEHICLES. WHEN AN EMERGENCY
VEHICLE APPROACHES PULL OVER AND
ALLOW THEM TO PASS. IF YOU ARE IN THE
ROUNDABOUT, PROCEED TO YOUR EXIT AND
THEN PULL OVER. NEVER STOP IN THE
ROUNDABOUT.

USH 2 WEST BOUND THROUGH TRAFFIC

MOVE TO LEFT LANE UPON APPROACH
TO THE ROUNDABOUT, SLOW TO ENTRY
SPEED AND ENTER THE ROUNDABOUT
WHEN AN OPPORTUNITY EXISTS.
TRAVEL AROUND THE CIRCLE AND EXIT
INTO THE WEST BOUND
LANE

SEE LINE STYLE - - - - -

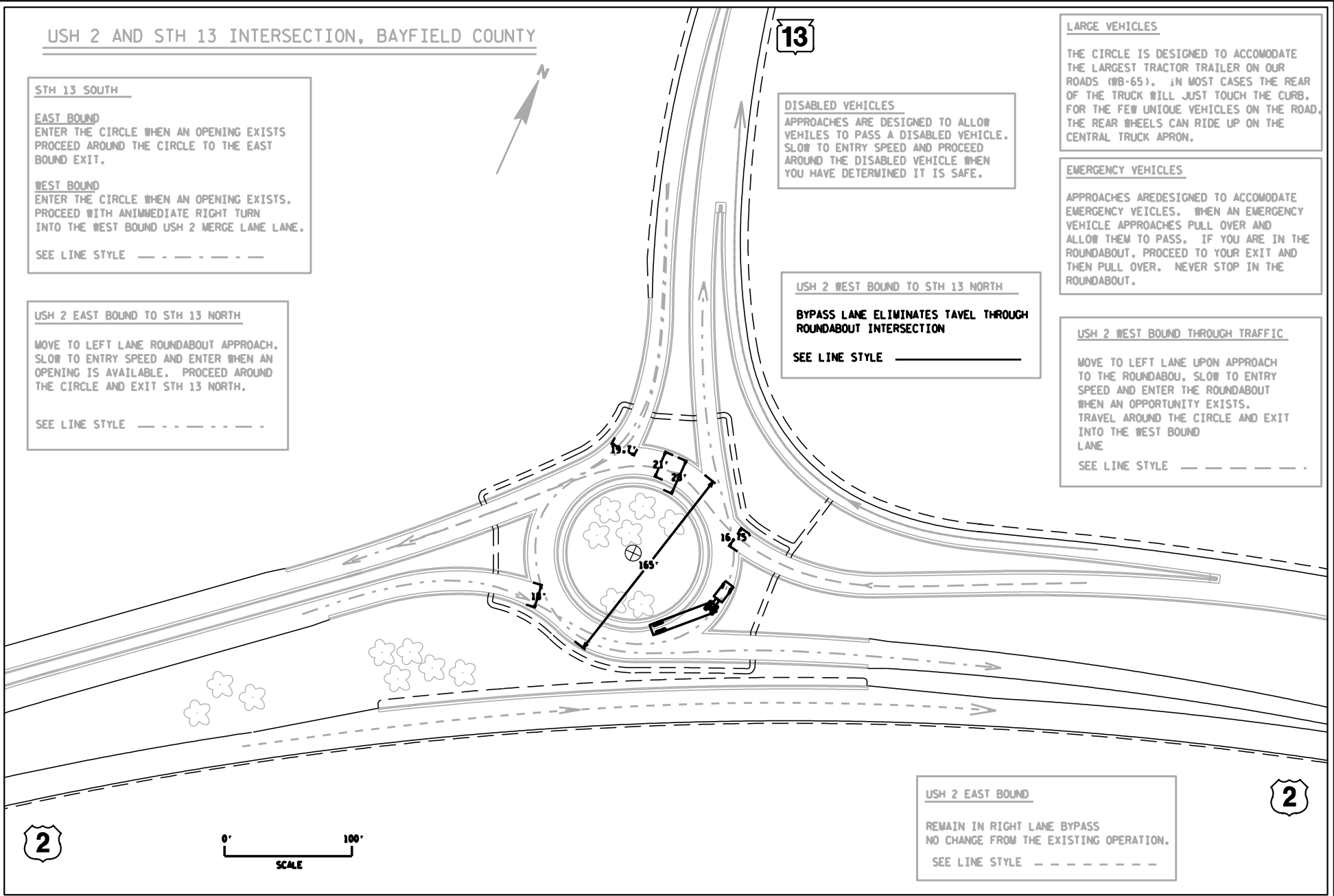

USH 2 EAST BOUND

REMAIN IN RIGHT LANE BYPASS
NO CHANGE FROM THE EXISTING OPERATION.

SEE LINE STYLE - - - - -

2

2

